

[Skip to content](#)

**Manuals+**

User Manuals Simplified.



## Redmi 38561 Buds 4 User Guide

October 14, 2022 [October 14, 2022](#) [Leave a comment on Redmi 38561 Buds 4 User Guide](#)

[Home](#) » [Redmi](#) » [Redmi 38561 Buds 4 User Guide](#) 📄

Document

# Redmi

## 38561 Buds 4 User Guide

Read this manual carefully before use, and retain it for future reference.

Illustrations of products, accessories, and user interfaces in the user manual are for reference purposes only. Actual product and functions may vary due to product enhancements.

**Contents** [hide](#)

[1 Product Overview](#)

[2 Charging](#)

[3 Turning On](#)

[4 Connection](#)

[5 Restoring factory settings](#)

[6 Function Overview](#)

[7 Specifications](#)

[8 Important Safety Information](#)

[9 Documents / Resources](#)

[9.1 References](#)

[10 Related Posts](#)

**Product Overview**

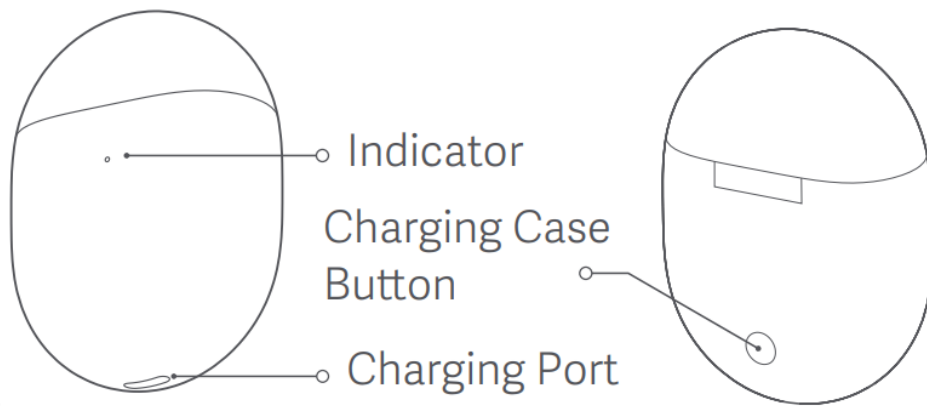

**Charging Case**

**Earbuds**

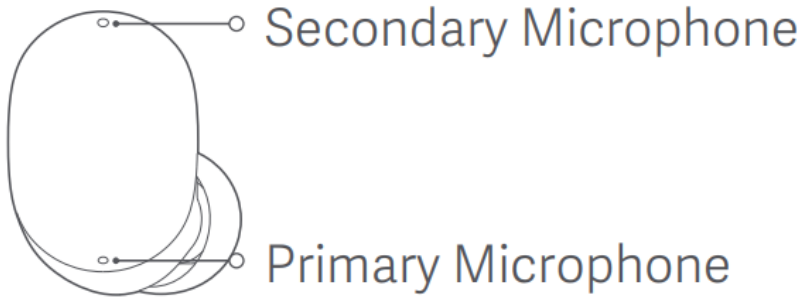

**First-time Use**

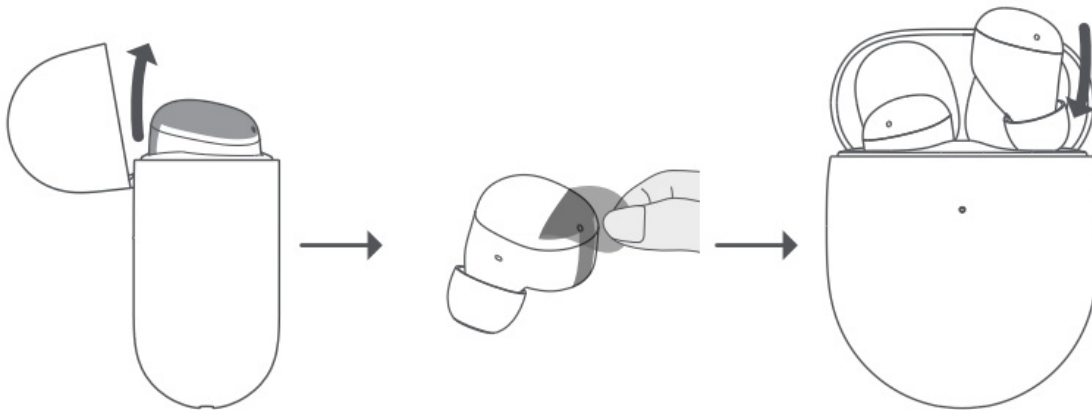

Open the lid and take out the earbuds.

Remove the protective film.

Put back for charging and open the lid for pairing.

**Charging**

Connect the charging cable to the charging case and keep the earbuds inside the case to charge simultaneously.

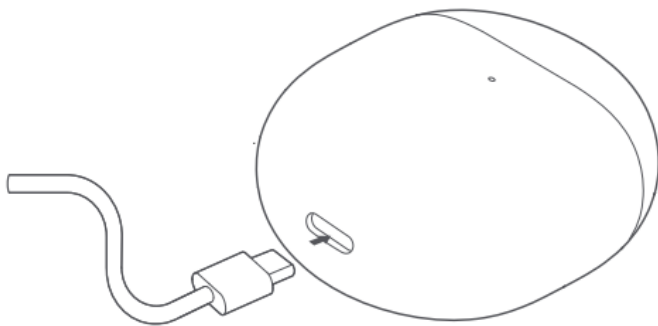



## Wearing

- Gently place the earbud into your ear canal, then adjust it to a comfortable position.
- During calls, make sure to point the primary microphone towards your mouth for clearer calls.

**Note:** The M-size ear tips are preinstalled. If feeling uncomfortable, please change to size L or S for a better fit.

## Turning On

Make sure the charging case is not out of battery with earbuds in it. Open the lid of the charging case, and the earbuds will automatically turn on.

## Turning Off

- Make sure the charging case is not out of battery. Put both earbuds back into the charging case and close the lid, they will automatically disconnect and start charging, and automatically turn off once fully charged.
- When turned on and out of the charging case, the earbuds will automatically turn off after about 1 hour if remaining disconnected from the device without any operations (such as being worn on or put back into the case).

## Connection

### First-time connection

After the charging case is opened, the indicator on it will blink white slowly for about 1 minute. During this period, enable the Bluetooth function on your phone, and then search and tap "Redmi Buds 4" to connect the earbuds. If the earbuds are connected successfully, the indicator will turn off after 7 seconds; otherwise, it will turn off automatically after blinking slowly for 1 minute. Note: If the earbuds cannot be connected, place them back into the charging case, close the lid and repeat the above operation.

### Connecting to other devices

Make sure the charging case is not out of battery and then place both earbuds in the case. Press and hold the charging case button for about 2 seconds to search and connect with the earbuds on a new device.

### Automatic connection

When the earbuds are in the charging case, opening the lid of the charging case will automatically connect the earbuds to the most recently used Bluetooth device. If the earbuds cannot successfully connect to any Bluetooth device within 10 minutes, they will automatically enter the low-power consumption mode.

### Disconnected

If the device's Bluetooth is disabled, or the earbuds are too far to connect with the device, the earbuds will automatically enter the awaiting connection mode. The earbuds will enter the low-power consumption mode if remaining disconnected for 10 minutes and turn off automatically after about 1 hour if no operation is made.

## Restoring factory settings

1. Place the earbuds into the charging case.
2. Press and hold the charging case button for at least 10 seconds until the indicator on the charging case stays on for about 3 seconds and then blinks slowly.
3. The earbuds are restored to the factory settings.  
The connection history has been cleared and the earbuds are waiting for a connection.

**Note:** Due to the technical characteristics of Bluetooth, there may be occasional intermittent loss of connection or sound in areas with dense electromagnetic signal interference at 2.4 GHz.

## Function Overview

**Note:** Once the weather is cold outdoors and your hands become dry, the buds may not function when touching them.

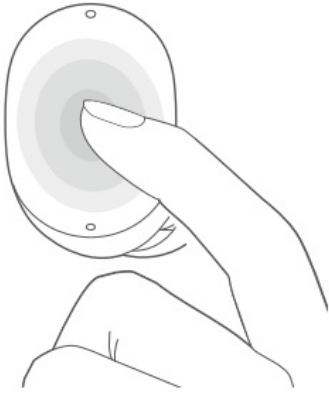

- **Answer/End calls**  
Double-tap: Answer a call  
Triple-tap: Decline or end a call Music
- **Double-tap: Pause or play**  
Triple tap: Play the next track  
Take out either earbud: Pause music
- **Change to noise cancellation mode**  
Press and hold either earbud to change the mode while wearing both buds.

## Specifications

Name: Wireless Earphones

Model: M2137E1

Frequency Band: 2402–2480 MHz

Max RF Output Power: < 20 mW

Storage Temperature: 0 °C to 45 °C

Operating Temperature: 0 °C to 45 °C

Service Life: 1 year

### Earbuds

Dimensions: 21.7 × 18.1 × 24.5 mm

Wireless Range: 10 m (in an obstacle-free environment)

Input: 5V<sup>⎓</sup> 100mA

Wireless Connectivity: Bluetooth® 5.2

### Charging Case

Model: M2137E1

Dimensions: 65 × 48.6 × 24.5 mm

Input: 5V<sup>⎓</sup> 450mA

Output: 5V<sup>⎓</sup> 240mA

## Important Safety Information

- The product has a built-in battery that can not be removed or replaced. To avoid damage to the battery or the product, do not disassemble or modify the battery by yourself. The battery can only be replaced by authorized service providers and must be replaced with the same type. Replacement of a battery with an incorrect type may defeat a safeguard (such as catching fire, explosion, and leakage of corrosive electrolyte). Do not dispose of used batteries with household waste. Disposal of this product and the used batteries shall comply with local laws and regulations.
- Do not attempt to disassemble, repair or modify the product, as this may cause fire or even completely damage the product.
- Keep the product's indicator away from the eyes of children and animals while the product is in use.
- Do not disassemble, puncture or crush the product nor expose it to fire.
- Please stop using the product immediately and seek medical assistance if the contact area on your skin shows signs of redness or swelling.



- To prevent possible hearing loss, do not use high volume for long periods of time.
- This product is not a toy and may contain small parts. Please keep them out of the reach of children.
- Disposal of a battery into fire or a hot oven or water or other liquids or mechanically crushing or cutting of a battery, that can result in an explosion.
- Leaving a battery in an extremely high temperature surrounding environment can result in an explosion or the leakage of flammable liquid or gas.
- A battery subjected to extremely low air pressure may result in an explosion or the leakage of flammable liquid or gas.
- Product information and certification marks are located in the Charging Case.
- <sup>⎓</sup> The symbol indicates DC voltage.

The Bluetooth® word mark and logos are registered trademarks owned by Bluetooth SIG, Inc. and any use of such marks by Xiaomi Inc. is under license. Other trademarks and trade names are those of their respective owners.

## EU DECLARATION OF CONFORMITY

Hereby, Chongqing Qianxing Technology Co., Ltd. declares that the radio equipment type M2137E1 is in compliance with Directive 2014/53/EU. The full text of the EU declaration of conformity is available at the following internet address: <http://www.mi.com/global/service/support/declaration.html>

 Hereby, Chongqing Qianxing Technology Co., Ltd. declares that the radio equipment type M2137E1 is in compliance with Radio Equipment Regulations 2017. The full text of the UKCA declaration of conformity is available at the following internet address: <https://www.mi.com/uk/service/support/declaration.html>



### WEEE Information

All products bearing this symbol are waste electrical and electronic equipment (WEEE as in directive 2012/19/EU) which should not be mixed with unsorted household waste. Instead, you should protect human health and the environment by handing over your waste equipment to a designated collection point for the recycling of waste electrical and electronic equipment, appointed by the government or local authorities. Correct disposal and recycling will help prevent potential negative consequences to the environment and human health. Please contact the installer or local authorities for more information about the location as well as the terms and conditions of such collection points.

 This device complies with part 15 of the FCC Rules.  
Operation is subject to the following two conditions:

1. This device may not cause harmful interference, and
2. this device must accept any interference received, including interference that may cause undesired operation.

Any changes or modifications not expressly approved by the party responsible for compliance could void the user's authority to operate the equipment.

**Note:** This equipment has been tested and found to comply with the limits for a Class B digital device, pursuant to part 15 of the FCC Rules. These limits are designed to provide reasonable protection against harmful interference in a residential installation. This equipment generates uses and can radiate radio frequency energy and, if not installed and used in accordance with the instructions, may cause harmful interference to radio communications. However, there is no guarantee that interference will not occur in a particular installation. If this equipment does cause harmful interference to radio or television reception, which can be determined by turning the equipment off and on, the user is encouraged to try to correct the interference by one or more of the following measures:

- Reorient or relocate the receiving antenna.
- Increase the separation between the equipment and the receiver.
- Connect the equipment to an outlet on a circuit different from that to which the receiver is connected.
- Consult the dealer or an experienced radio/TV technician for help.

This equipment complies with FCC/ISED radiation exposure limits set forth for an uncontrolled environment. The end user must follow the specific operating instructions for satisfying RF exposure compliance. This transmitter must not be co-located or operating in conjunction with any other antenna or transmitter.

- The portable device is designed to meet the requirements for exposure to radio waves established by the ISED. These requirements set a SAR limit of 1.6 W/kg averaged over one gram of tissue.

This device contains license-exempt transmitter(s)/receiver(s) that comply with Innovation, Science, and Economic Development Canada's license-exempt RSS(s). Operation is subject to the following two conditions:

1. This device may not cause interference.
2. This device must accept any interference, including interference that may cause undesired operation of the device.



CS34564  
Energy Efficiency  
Verified

IC: 2042B-M2137E1  
CAN ICES-003(B)/NMB-003(B)  
Manufactured for: Xiaomi Communications Co., Ltd.  
Manufactured by: Chongqing Qianxing Technology Co., Ltd.  
(a Mi Ecosystem company)  
Address: No. 8, Shuangxing Avenue, Biquan Street, Bishan District, Chongqing Municipality China  
User Manual Version: V1.0  
For further information, please go to [www.mi.com](http://www.mi.com)

## Documents / Resources

 [Redmi 38561 Buds 4 \[pdf\] User Guide](#)  
M2137E1, 2AW4L-M2137E1, 2AW4LM2137E1, 38561 Buds 4, 38561, Buds 4, Earbuds

## References

-  [Stream TV | Purifier | Earbuds | Power Bank - Xiaomi United States](#)

## Related Posts



### [Amazon Echo Buds User Guide](#)

Amazon Echo Buds

### [MacBook User Guide](#)

MacBook User Guide - Download [optimized]MacBook User Guide - Download



### [Fitpolo F1 Bluetooth Earbuds User Guide](#)

Fitpolo F1 Bluetooth Earbuds User Guide Dimensions



### [TRUEFREE A1 Wireless Earbuds User Guide](#)

A1 Wireless Earbuds

## Leave a comment

Your email address will not be published. Required fields are marked \*

Comment \*

Name

Email

Website

Save my name, email, and website in this browser for the next time I comment.

[Manuals+](#),

- [home](#)
- [privacy](#)