

GAS LIFT REMOVAL GUIDE

Parts List

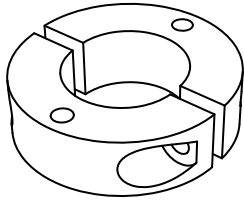

2x

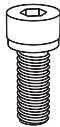

4x



2x

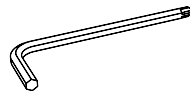

1x



1x

1

Use the chair lift lever to raise your office chair to the highest position.

2

Lay the office chair on its side. Separate the two provided shaft collars and attach them to the old chair cylinder using the shorter screws and Allen wrench. Slide both shaft collars as close as you can to the chair mechanism.

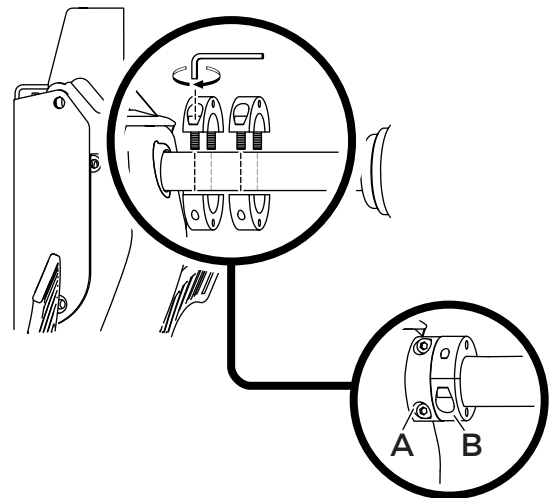
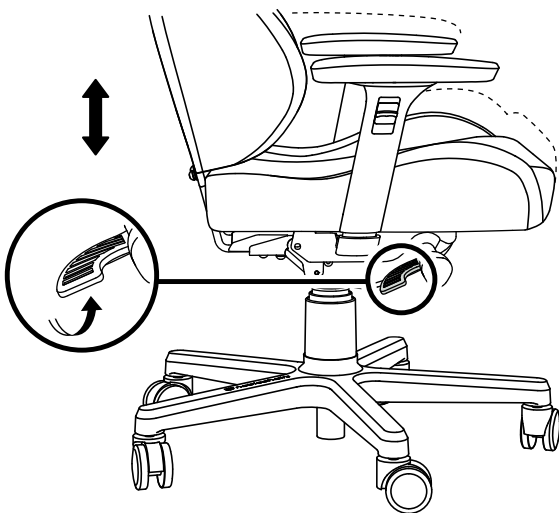

Tighten only shaft collar B so it clamps the cylinder very tightly and is not able to slide. (make sure the threaded holes in both shaft collars are **not directly aligned**)

3 Use the two longer screws to thread into shaft collar B. Using the Allen Wrench, tighten both screws evenly so they begin to press against the shaft collar A.

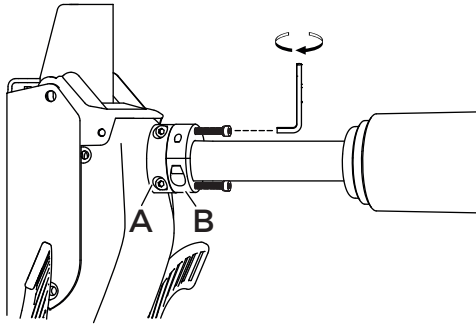

4 As you continue to tighten these screws, shaft collar A will start to slide and the cylinder will pull away from the chair mechanism.

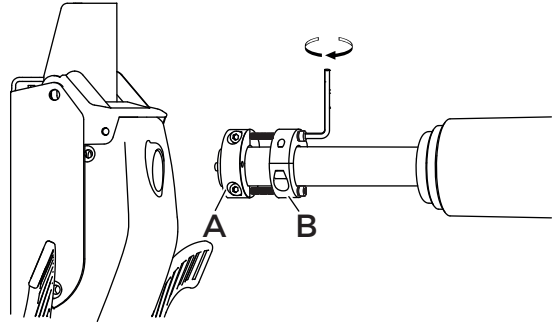

5 Use a rubber mallet or hammer with wooden block to strike the bottom edge of the old cylinder until the base is separated from the cylinder.

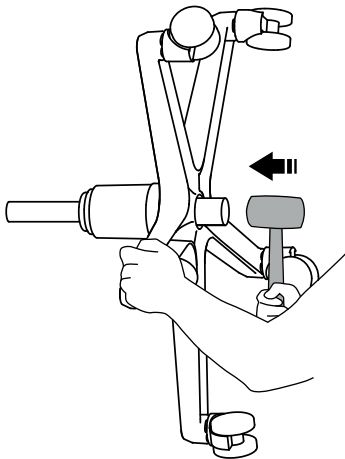

If you have any questions please don't hesitate to contact us.



Please be careful when using a hammer to remove the base to avoid injury.